

*Draught*  
 Lykens Valley Coal Company  
 Wicomico Township, Berks County  
 Henry Sheaffer  
 Berks County  
 1294 68 1/2 ps. & allowance  
 99 - 263 - - -  
 11 - 1183 - - -

(Endorsement on back)

Dauphin County  
 Wm. Fox & H. Sheaffer  
 217 1/2 103 0 1/2  
 Plat. ge. 263 Nov. 1836

Accepted as Nov 1836  
 263 Dauphin 5.

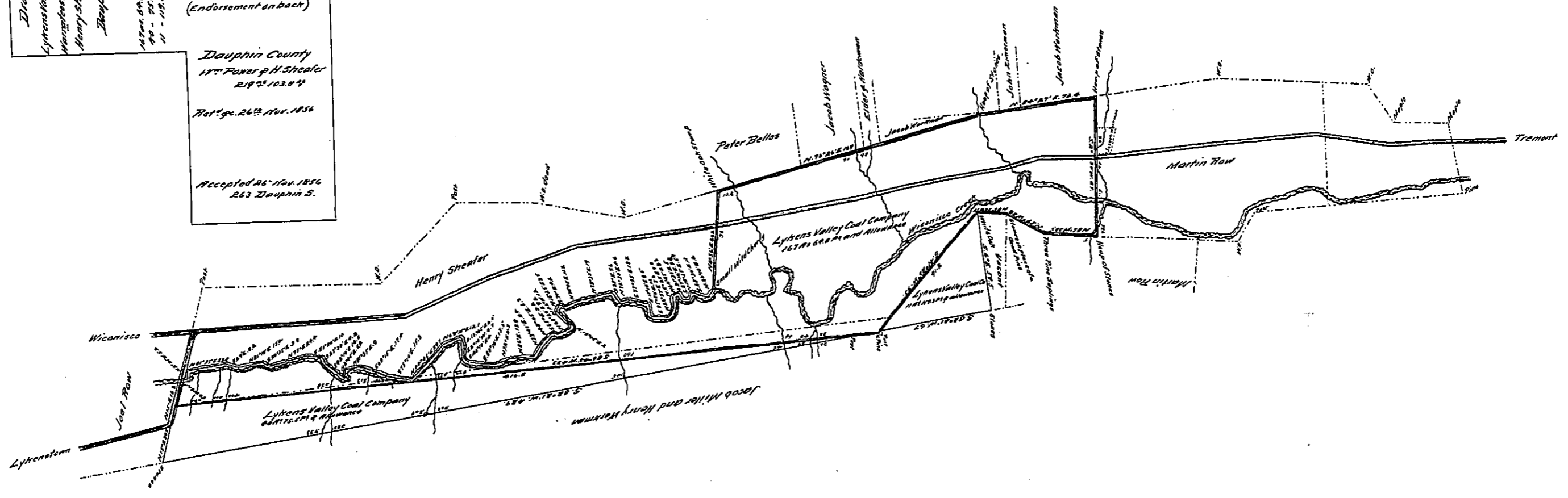

*A connected draught of three tracts of land, belonging to the Lykens Valley Coal Company, situate in Wicomico Township, Dauphin County, Pennsylvania. The one embraced within the red lines (containing 167 1/2 68 1/2 ps. & allowance) being part of a larger tract of 372 ac. and allowance, which was reserved for William Power, on the 3rd & 4th days of December, 1799, in pursuance of his warrant of the 14th day of July, A.D. 1778. The two embraced within the yellow lines, (the one containing 49 05 36 ps. & allowance; the other containing 11 ac. 1183 ps. & allowance,) being parts of the tract of 49 ac. 36 ps. & allowance, which was surveyed for Henry Sheaffer, on the 15th day of November, 1833, in pursuance of his warrant, bearing date the 7th day of January, 1833. Resurveyed for the Lykens Valley Coal Company, in the months of March and April, A.D. 1856, by*

*Daniel Hoffman.*

*To James Porter Branley, Esqr.  
 Surveyor General, Pennsylvania.*

*In Testimony, That the above is a copy of the original remaining on file in the Department of Internal Affairs of Pennsylvania, made conformably to an Act of Assembly approved the 16th day of February, 1833, I have hereunto set my Hand and caused the Seal of the said Department to be affixed, at Harrisburg, the third day of August A.D. 1911.*

*Henry Howell  
 Secretary of Internal Affairs*